

CH C-TYPE standard version

inserts		page:
CD	64 poles + ⊕	72
CDD	108 poles + ⊕	81
CDS	42 poles + ⊕	-
CDSH	42 poles + ⊕	89
CNE	24 poles + ⊕	113
CSE	24 poles + ⊕	-
CSH	24 poles + ⊕	113
CSH S	24 poles + ⊕	125
CCE	24 poles + ⊕	133
CMSH	10+2 (aux) poles + ⊕	140
CMCE	10+2 (aux) poles + ⊕	141
CSS	24 poles + ⊕	151
CT, CTS (10A) *)	64 poles + ⊕	157
CT, CTSE (16A) *)	24 poles + ⊕	163
CQE	46 poles + ⊕	171
CQEE	64 poles + ⊕	177
CX	4/8 and 6/6 poles + ⊕	204 and 206
MIXO	6 modules	262 - 317

*) can be used only in bulkhead mounting housings

bulkhead mounting housings with 2 levers or 4 pegs



bulkhead mounting housings with single lever



description	part No.	part No.
with one or two levers	CHI 24	CHI 24 L
with pegs 1)	CHI 24 C	
with pegs and aluminum cover 1)	CHI 24 CS	
with pegs and plastic cover 1)	CHI 24 CP	
with lever and aluminum cover		CHI 24 LS

1) may be combined with enclosures:
 - CHO/CAO 24 X and CHV/CAV 24 X
 - MHO/MAO 24 X and MHV/MAV 24 X

panel cut-out for bulkhead mounting housings

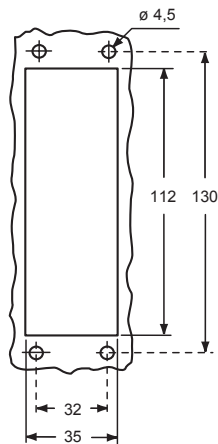

IMPORTANT NOTE: The enclosures ensure IP66/IP69 degree of protection (or IP65 for hinged cover versions) when mated and locked with the closing levers. The cover (CS, CP) only ensures mechanical protection, but does not ensure IP65 degree of protection.

CR CLK
locking device for CLASS locking levers (page 666)



CAUS® Type 4/4X/12
(except enclosures with plastic cover)



CHI ▲

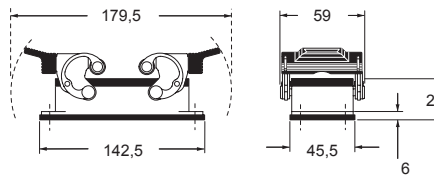

CHI C ▲

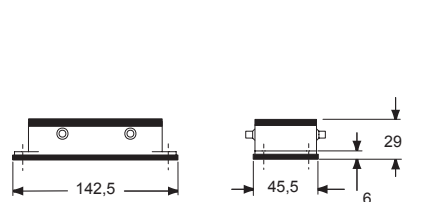

CHI CS/CP ●

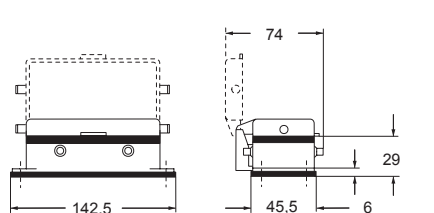

CHI L ▲

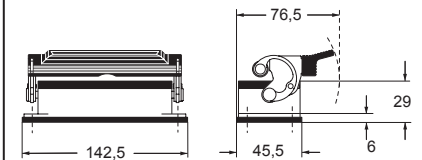

CHI LS ●

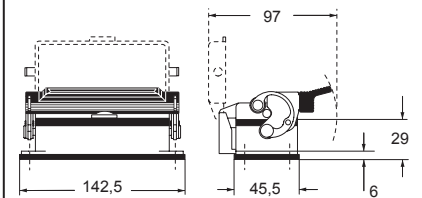

CH - CA and MH - MA C-TYPE standard version

inserts		page:
CD	64 poles + ⊕	72
CDD	108 poles + ⊕	81
CDS	42 poles + ⊕	-
CDSH	42 poles + ⊕	89
CNE	24 poles + ⊕	113
CSE	24 poles + ⊕	-
CSH	24 poles + ⊕	113
CSH S	24 poles + ⊕	125
CCE	24 poles + ⊕	133
CMSH	10+2 (aux) poles + ⊕	140
CMCE	10+2 (aux) poles + ⊕	141
CSS	24 poles + ⊕	151
CQE	46 poles + ⊕	171
CQEE	64 poles + ⊕	177
CX	4/8 and 6/6 poles + ⊕	204 and 206
MIXO	6 modules	262 - 317

surface mounting housings with 2 levers or 4 pegs



surface mounting housings with single lever

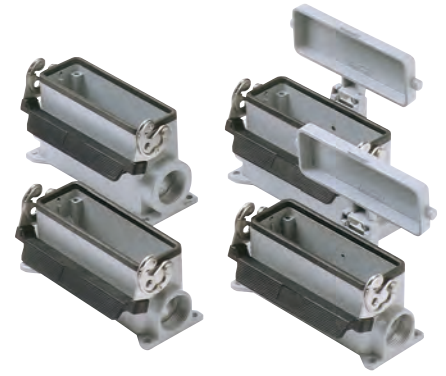

description	part No.	entry Pg	part No.	entry M	part No.	entry Pg	part No.	entry M
with lever/s	CHP 24	21	MHP 24.25	25	CHP 24 L	21	MHP 24 L25	25
with lever/s	CHP 24.2	21 x 2	MHP 24.225	25 x 2	CHP 24 L2	21 x 2	MHP 24 L225	25 x 2
with levers, high construction 1)			MAP 24.25	25				
with levers, high construction 1)			MAP 24.225	25 x 2				
with lever/s, high construction	CAP 24.21	21	MAP 24.32	32	CAP 24 L	21	MAP 24 L32	32
with lever/s, high construction	CAP 24.221	21 x 2	MAP 24.232	32 x 2	CAP 24 L2	21 x 2	MAP 24 L232	32 x 2
with lever/s, high construction	CAP 24.29	29	MAP 24.40	40	CAP 24 L29	29	MAP 24 L40	40
with lever/s, high construction	CAP 24.229	29 x 2	MAP 24.240	40 x 2	CAP 24 L229	29 x 2	MAP 24 L240	40 x 2
with pegs and aluminum cover 2)	CHP 24 CS	21	MHP 24 CS25	25				
with pegs and aluminum cover 2)	CHP 24 CS2	21 x 2	MHP 24 CS225	25 x 2				
with pegs and aluminum cover, high construction 2)	CAP 24 CS	21	MAP 24 CS32	32				
with pegs and aluminum cover, high construction 2)	CAP 24 CS2	21 x 2	MAP 24 CS232	32 x 2				
with pegs and aluminum cover, high construction 2)	CAP 24 CS29	29	MAP 24 CS40	40				
with pegs and aluminum cover, high construction 2)	CAP 24 CS229	29 x 2	MAP 24 CS240	40 x 2				
with pegs and plastic cover 2)	CHP 24 CP	21	MHP 24 CP25	25				
with pegs and plastic cover 2)	CHP 24 CP2	21 x 2	MHP 24 CP225	25 x 2				
with pegs and plastic cover, high construction 2)	CAP 24 CP	21	MAP 24 CP32	32				
with pegs and plastic cover, high construction 2)	CAP 24 CP2	21 x 2	MAP 24 CP232	32 x 2				
with pegs and plastic cover, high construction 2)	CAP 24 CP29	29	MAP 24 CP40	40				
with pegs and plastic cover, high construction 2)	CAP 24 CP229	29 x 2	MAP 24 CP240	40 x 2				
with lever and aluminium cover	CHP 24 LS	21	MHP 24 LS25	25				
with lever and aluminium cover	CHP 24 LS2	21 x 2	MHP 24 LS225	25 x 2				
with lever and aluminium cover, high construction	CAP 24 LS	21	MAP 24 LS32	32				
with lever and aluminium cover, high construction	CAP 24 LS2	21 x 2	MAP 24 LS232	32 x 2				
with lever and aluminium cover, high construction	CAP 24 LS29	29	MAP 24 LS40	40				
with lever and aluminium cover, high construction	CAP 24 LS229	29 x 2	MAP 24 LS240	40 x 2				

1) can only be used with a complete cable gland (to be purchased separately)

2) may be combined with enclosures:
 - CHO/CAO 24 X and CHV/CAV 24 X
 - MHO/MAO 24 X and MHV/MAV 24 X

IMPORTANT NOTE: The enclosures ensure IP66/IP69 degree of protection (or IP65 for hinged cover versions) when mated and locked with the closing levers. The cover (CS, CP) only ensures mechanical protection, but does not ensure IP65 degree of protection.

CR CLK
locking device for CLASS locking levers (page 666)



CAUS® Type 4/4X/12
(except enclosures with plastic cover)



insulating cable gland or fittings without gasket



cable gland with O-Ring gasket

CHP - CAP and MHP - MAP ▲

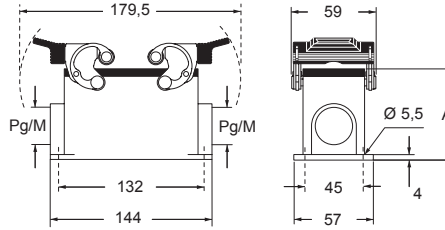

CHP CS/CP - CAP CS/CP and MHP CS/CP - MAP CS/CP ●

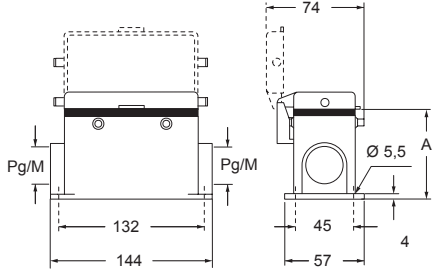

type	A
CHP / MHP	63
CAP / MAP	81
CHP CS / MHP CS	63
CAP CS / MAP CS	81
CHP CP / MHP CP	63
CAP CP / MAP CP	81

CHP L - CAP L and MHP L - MAP L ▲

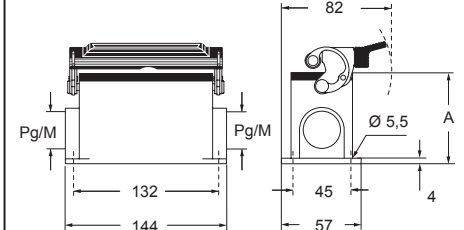

CHP LS - CAP LS and MHP LS - MAP LS ●

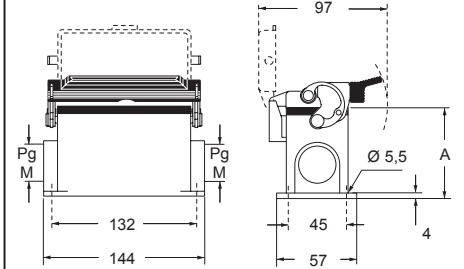

type	A
CHP L / MHP L	63
CAP L / MAP L	81
CHP LS / MHP LS	63
CAP LS / MAP LS	81

CH - CA - CF and MH - MA - MF C-TYPE standard version

inserts		page:
CD	64 poles + ⊕	72
CDD	108 poles + ⊕	81
CDS	42 poles + ⊕	-
CDSH	42 poles + ⊕	89
CNE	24 poles + ⊕	113
CSE	24 poles + ⊕	-
CSH	24 poles + ⊕	113
CSH S	24 poles + ⊕	125
CCE	24 poles + ⊕	133
CMSH	10+2 (aux) poles + ⊕	140
CMCE	10+2 (aux) poles + ⊕	141
CSS	24 poles + ⊕	151
CQE	46 poles + ⊕	171
CQEE	64 poles + ⊕	177
CX	4/8 and 6/6 poles + ⊕	204 and 206
MIXO	6 modules	262 - 317

hoods with 4 pegs



hoods with 4 pegs

M40 cable entry with 20 mm thread length

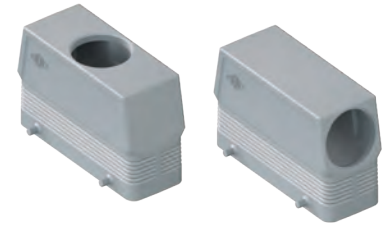

description	part No.	entry Pg	part No.	entry M	part No.	entry Pg	part No.	entry M
with pegs, side entry	CHO 24	21	MHO 24.25	25				
with pegs, side entry			MHO 24.32	32				
with pegs, side entry, high construction	CAO 24.21	21	MAO 24.32	32				
with pegs, side entry, high construction	CAO 24.29	29	MAO 24.40	40				
with pegs, side entry, high construction, without adapter 1)					CFO 24.21	21	MFO 24.32	32
with pegs, side entry, high construction, without adapter 1)					CFO 24.29	29	MFO 24.40	40
with pegs, top entry	CHV 24	21						
with pegs, top entry 2)			MHV 24.25	25				
with pegs, top entry			MHV 24.32	32				
with pegs, top entry	CHV 24.29	29	MHV 24.40	40				
with pegs, top entry, high construction	CAV 24.21	21	MAV 24.32	32				
with pegs, top entry, high construction	CAV 24.29	29	MAV 24.40	40				
with pegs, top entry, high construction, without adapter 1)					CFV 24.21	21	MFV 24.32	32
with pegs, top entry, high construction, without adapter 1)					CFV 24.29	29	MFV 24.40	40
with pegs, frontal entry, high construction	CAF 24.21	21	MAF 24.25	25				
with pegs, frontal entry, high construction	CAF 24.29	29	MAF 24.32	32				
with pegs, frontal entry, high construction, without adapter 1)	CFF 24.21	21	MFF 24.25	25				
with pegs, frontal entry, high construction, without adapter 1)	CFF 24.29	29	MFF 24.32	32				

1) enclosure without adapter, threaded on the body, to be used only with a complete cable gland.

2) can only be used with a complete cable gland (to be purchased separately).

IP degrees are according to the type of lever of the counterpart enclosures.

Alternatively, hoods with pegs may be coupled with fixed enclosures:

- C-TYPE, IP65 or IP66/IP69 stainless steel lever, from page 412 to page 422
- C7, IP66/IP67/IP69 stainless steel lever, page 441
- CV, IP65 or IP66/IP69 stainless steel lever, page 460 and 461

CHO (CAO) and MHO (MAO)

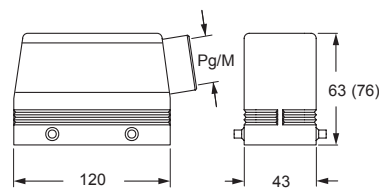

CFO and MFO

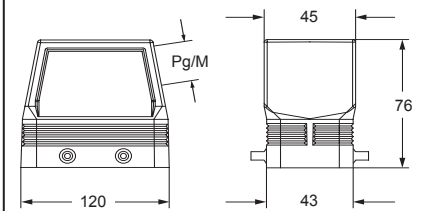

CHV (CAV) and MHV (MAV)

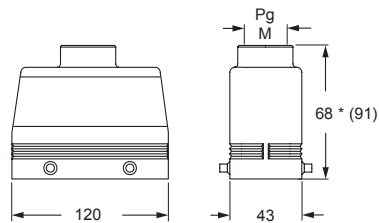

CFV and MFV

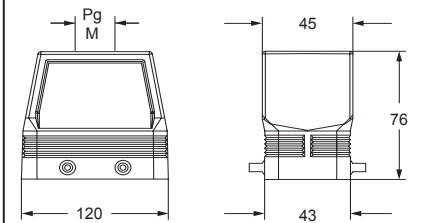

* 69,5 for Pg 29 - M40 versions

CAF/CFF and MAF/MFF

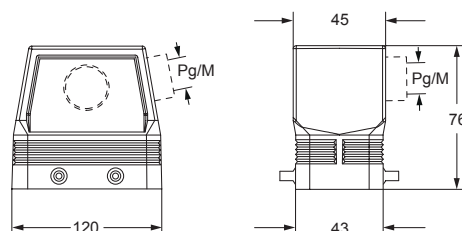

CALUS® Type 4/4X/12



insulating cable gland or fittings without gasket



cable gland with O-Ring gasket
IP67 if hoods without adapters coupled with IP67 housings

CH - CA - CF and MH - MA - MF C-TYPE standard version

inserts		page:
CD	64 poles + ⊕	72
CDD	108 poles + ⊕	81
CDS	42 poles + ⊕	-
CDSH	42 poles + ⊕	89
CNE	24 poles + ⊕	113
CSE	24 poles + ⊕	-
CSH	24 poles + ⊕	113
CSH S	24 poles + ⊕	125
CCE	24 poles + ⊕	133
CMSH	10+2 (aux) poles + ⊕	140
CMCE	10+2 (aux) poles + ⊕	141
CSS	24 poles + ⊕	151
CQE	46 poles + ⊕	171
CQEE	64 poles + ⊕	177
CX	4/8 and 6/6 poles + ⊕	204 and 206
MIXO	6 modules	262 - 317

hoods with 2 pegs



hoods with 2 pegs M40 cable entry with 20 mm thread length



description	part No.	entry Pg	part No.	entry M	part No.	entry Pg	part No.	entry M
with pegs, side entry	CHO 24 L	21	MHO 24 L25	25				
with pegs, side entry			MHO 24 L32	32				
with pegs, side entry, high construction	CAO 24 L21	21	MAO 24 L32	32				
with pegs, side entry, high construction	CAO 24 L29	29	MAO 24 L40	40				
with pegs, side entry, high construction, without adapter ¹⁾					CFO 24 L21	21	MFO 24 L32	32
with pegs, side entry, high construction, without adapter ¹⁾					CFO 24 L29	29	MFO 24 L40	40
with pegs, top entry	CHV 24 L	21						
with pegs, top entry ²⁾			MHV 24 L25	25				
with pegs, top entry			MHV 24 L32	32				
with pegs, top entry	CHV 24 L29	29	MHV 24 L40	40				
with pegs, top entry, high construction	CAV 24 L21	21	MAV 24 L32	32				
with pegs, top entry, high construction	CAV 24 L29	29	MAV 24 L40	40				
with pegs, top entry, high construction, without adapter ¹⁾					CFV 24 L21	21	MFV 24 L32	32
with pegs, top entry, high construction, without adapter ¹⁾					CFV 24 L29	29	MFV 24 L40	40

¹⁾ enclosure without adapter, threaded on the body, to be used only with a complete cable gland.

²⁾ can only be used with a complete cable gland (to be purchased separately).

IP degrees are according to the type of lever of the counterpart enclosures.

Alternatively, hoods with pegs may be coupled with fixed enclosures:

- C-TYPE, IP65 or IP66/IP69 stainless steel lever, from page 412 to page 422
- CV, IP65 or IP66/IP69 stainless steel lever, page 460 and 461

CHO L (CAO L) and MHO L (MAO L)

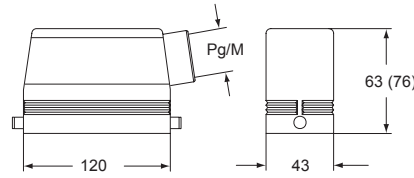

CFO L and MFO L

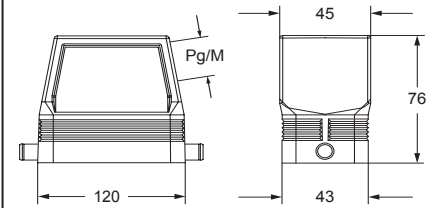

CHV L (CAV L) and MHV L (MAV L)

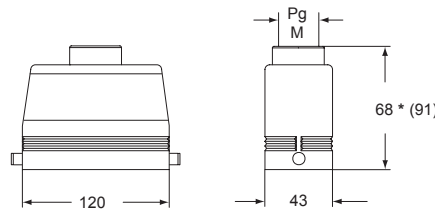

CFV L and MFV L

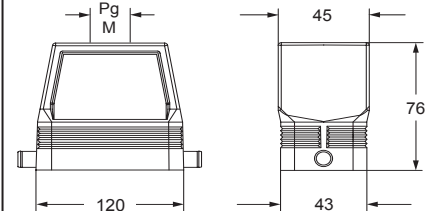

* 69,5 for Pg 29 - M40 versions

CRU® Type 4/4X/12

insulating cable gland or fittings without gasket

cable gland with O-Ring gasket

CA - CF and MA - MF C-TYPE standard version

inserts		page:
CD	64 poles + ⊕	72
CDD	108 poles + ⊕	81
CDS	42 poles + ⊕	-
CDSH	42 poles + ⊕	89
CNE	24 poles + ⊕	113
CSE	24 poles + ⊕	-
CSH	24 poles + ⊕	113
CSH S	24 poles + ⊕	125
CCE	24 poles + ⊕	133
CMSH	10+2 (aux) poles + ⊕	140
CMCE	10+2 (aux) poles + ⊕	141
CSS	24 poles + ⊕	151
CQE	46 poles + ⊕	171
CQEE	64 poles + ⊕	177
CX	4/8 and 6/6 poles + ⊕	204 and 206
MIXO	6 modules	262 - 317

hoods with double top entry and 4 pegs



hoods with double front entry and 4 pegs



description	part No.	entry Pg	part No.	entry M	part No.	entry Pg	part No.	entry M
with pegs for two levers used with enclosures size "104.27"	CAV 24.221	21 x 2	MAV 24.232	32 x 2				
used with enclosures size "104.27"	CAV 24.229	29 x 2						
with pegs for 2 levers, without adapter 1) used with enclosures size "104.27"	CFV 24.221	21 x 2	MFV 24.232	32 x 2				
with pegs for two levers used with enclosures size "104.27"					CAF 24.221	21 x 2	MAF 24.225	25 x 2
with pegs for 2 lever, without adapter 1) used with enclosures size "104.27"					CFF 24.221	21 x 2	MFF 24.225	25 x 2

1) enclosure without adapter, threaded on the body, to be used only with a complete cable gland.

IP degrees are according to the type of lever of the counterpart enclosures.
Alternatively, hoods with pegs may be coupled with fixed enclosures:
- C-TYPE, IP65 or IP66/IP69 stainless steel lever, from page 412 to page 422
- C7, IP66/IP67/IP69 stainless steel lever, page 441
- CV, IP65 or IP66/IP69 stainless steel lever, page 460 and 461

CAV/CFV and MAV/MFV

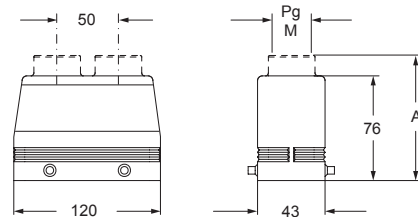

part No.	A
CAV 24.221 - MAV 24.232	90,5 (91)
CAV 24.229	90,5
CFV 24.221 - MFV 24.232	-

CAF/CFF and MAF/MFF

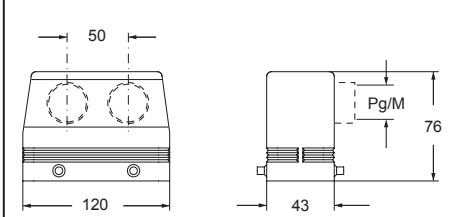

CAU[®] US Type 4/4X/12



insulating cable gland or fittings without gasket



cable gland with O-Ring gasket
IP67 if hoods without adapters coupled with IP67 housings

CI and MI C-TYPE standard version

inserts		page:
CD	64 poles + ⊕	72
CDD	108 poles + ⊕	81
CDS	42 poles + ⊕	-
CDSH	42 poles + ⊕	89
CNE	24 poles + ⊕	113
CSE	24 poles + ⊕	-
CSH	24 poles + ⊕	113
CSH S	24 poles + ⊕	125
CCE	24 poles + ⊕	133
CMSH	10+2 (aux) poles + ⊕	140
CMCE	10+2 (aux) poles + ⊕	141
CSS	24 poles + ⊕	151
CQE	46 poles + ⊕	171
CQEE	64 poles + ⊕	177
CX	4/8 and 6/6 poles + ⊕	204 and 206
MIXO	6 modules	262 - 317

inclined hoods for 2 levers with side entry



inclined hoods for 2 levers with top entry



description	part No.	entry Pg	part No.	entry M	part No.	entry Pg	part No.	entry M
used with enclosures size "104.27" with pegs for two levers, side entry	CIO 24.36	36	MIO 24.40	40				
with pegs for two levers, side entry			MIO 24.50	50				
used with enclosures size "104.27" with pegs for two levers, top entry	CIV 24.36	36			MIV 24.40	40		
with pegs for two levers, top entry					MIV 24.50	50		

IP degrees are according to the type of lever of the counterpart enclosures.

Alternatively, hoods with pegs may be coupled with fixed enclosures:

- C-TYPE, IP65 or IP66/IP69 stainless steel lever, from page 412 to page 422
- C7, IP66/IP67/IP69 stainless steel lever, page 441
- CV, IP65 or IP66/IP69 stainless steel lever, page 460 and 461

CIO and MIO

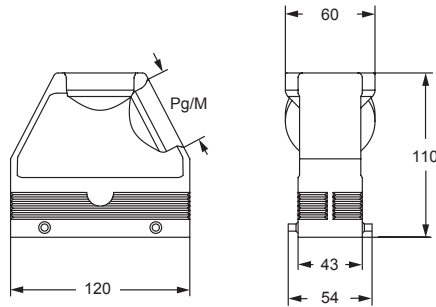

CIV and MIV

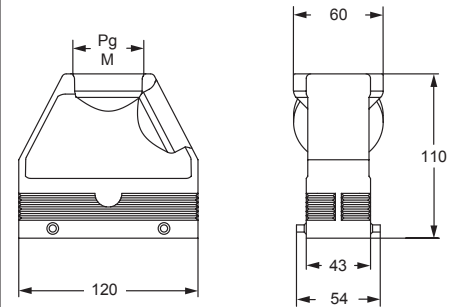

CAVUS® Type 4/4X/12

insulating cable gland or fittings without gasket

cable gland with O-Ring gasket according to the type of lever

CQ and MQ C-TYPE standard version

inserts		page:
CD	64 poles + ⊕	72
CDD	108 poles + ⊕	81
CDS	42 poles + ⊕	-
CDSH	42 poles + ⊕	89
CNE	24 poles + ⊕	113
CSE	24 poles + ⊕	-
CSH	24 poles + ⊕	113
CSH S	24 poles + ⊕	125
CCE	24 poles + ⊕	133
CMSH	10+2 (aux) poles + ⊕	140
CMCE	10+2 (aux) poles + ⊕	141
CSS	24 poles + ⊕	151
CQE	46 poles + ⊕	171
CQEE	64 poles + ⊕	177
CX	4/8 and 6/6 poles + ⊕	204 and 206
MIXO	6 modules	262 - 317

enlarged hoods,
side or top entry with 4 pegs

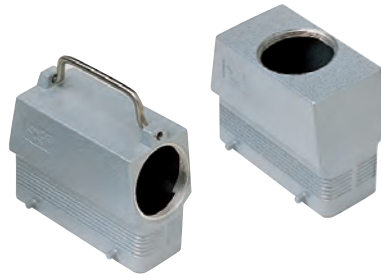

description	part No.	entry Pg	part No.	entry M
used with enclosures size "104.27"				
with pegs for two levers, side entry, without adapter 1)	CQO 24	36	MQO 24.40	40
with pegs for two levers, top entry, without adapter 1)	CQV 24	36	MQV 24.40	40

1) enclosure without adapter, threaded on the body, to be used only with a complete cable gland.

IP degrees are according to the type of lever of the counterpart enclosures.

Alternatively, hoods with pegs may be coupled with fixed enclosures:

- C-TYPE, IP65 or IP66/IP69 stainless steel lever, from page 412 to page 422
- C7, IP66/IP67/IP69 stainless steel lever, page 441
- CV, IP65 or IP66/IP69 stainless steel lever, page 460 and 461

CQO and MQO

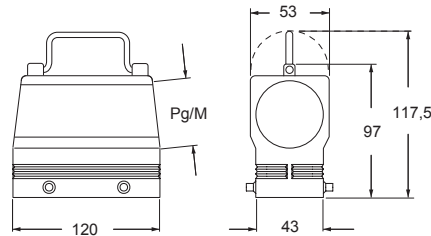

CQV and MQV

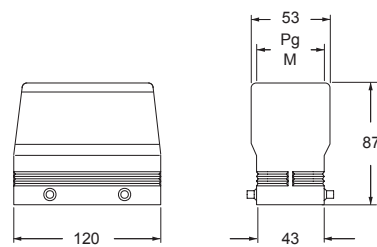

CAVUS® Type 4/4X/12

 insulating cable gland or fittings without gasket

 cable gland with O-Ring gasket according to the type of lever

CH - CA - CF and MH - MA - MF C-TYPE standard version

inserts		page:
CD	64 poles + ⊕	72
CDD	108 poles + ⊕	81
CDS	42 poles + ⊕	-
CDSH	42 poles + ⊕	89
CNE	24 poles + ⊕	113
CSE	24 poles + ⊕	-
CSH	24 poles + ⊕	113
CSH S	24 poles + ⊕	125
CCE	24 poles + ⊕	133
CMSH	10+2 (aux) poles + ⊕	140
CMCE	10+2 (aux) poles + ⊕	141
CSS	24 poles + ⊕	151
CQE	46 poles + ⊕	171
CQEE	64 poles + ⊕	177
CX	4/8 and 6/6 poles + ⊕	204 and 206
MIXO	6 modules	262 - 317

hoods with 2 levers



hoods with 2 levers M40 cable entry with 20 mm thread length



description	part No.	entry Pg	part No.	entry M	part No.	entry M
with levers and gasket, side entry, high construction, without adapter ¹⁾					MFO 24 G40	40
with levers and gasket, top entry	CHV 24 G	21	MHV 24 G32	32		
with levers and gasket, top entry, high construction	CAV 24 G	21	MAV 24 G25	25		
with levers and gasket, top entry, high construction	CAV 24 G29	29	MAV 24 G32	32		
with levers and gasket, top entry, high construction			MAV 24 G40	40		
with levers and gasket, top entry, high construction, without adapter ¹⁾	CFV 24 G	21	MFV 24 G25	25		
with levers and gasket, top entry, high construction, without adapter ¹⁾	CFV 24 G29	29	MFV 24 G32	32		
with levers and gasket, top entry, high construction, without adapter ¹⁾					MFV 24 G40	40

¹⁾ enclosure without adapter, threaded on the body, to be used only with a complete cable gland.

CHV G (CAV G) and [CFV G], MHV G (MAV G) and [MFV G]

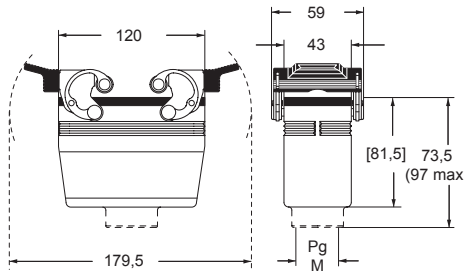

MFO 24 G40

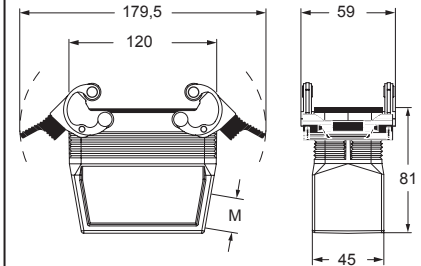

MFV 24 G40

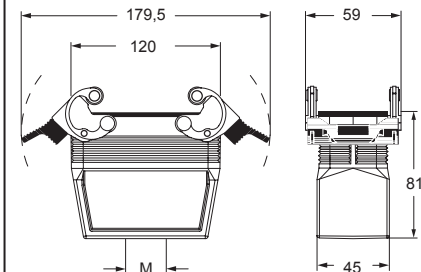

CAVUS® Type 4/4X/12

insulating cable gland or fittings without gasket

cable gland with O-Ring gasket

CH - CA - CF and MH - MA - MF C-TYPE standard version

inserts		page:
CD	64 poles + ⊕	72
CDD	108 poles + ⊕	81
CDS	42 poles + ⊕	-
CDSH	42 poles + ⊕	89
CNE	24 poles + ⊕	113
CSE	24 poles + ⊕	-
CSH	24 poles + ⊕	113
CSH S	24 poles + ⊕	125
CCE	24 poles + ⊕	133
CMSH	10+2 (aux) poles + ⊕	140
CMCE	10+2 (aux) poles + ⊕	141
CSS	24 poles + ⊕	151
CQE	46 poles + ⊕	171
CQEE	64 poles + ⊕	177
CX	4/8 and 6/6 poles + ⊕	204 and 206
MIXO	6 modules	262 - 317

hoods with 1 lever



hoods with 1 lever
M40 cable entry with 20 mm thread length



description	part No.	entry Pg	part No.	entry M	part No.	entry M
with lever and gasket, side entry, high construction, without adapter 1)					MFO 24 LG40	40
with lever and gasket, top entry	CHV 24 LG	21	MHV 24 LG32	32		
with lever and gasket, top entry, high construction	CAV 24 LG21	21	MAV 24 LG25	25		
with lever and gasket, top entry, high construction	CAV 24 LG29	29	MAV 24 LG32	32		
with lever and gasket, top entry, high construction			MAV 24 LG40	40		
with lever and gasket, top entry, high construction, without adapter 1)	CFV 24 LG21	21	MFV 24 LG25	25		
with lever and gasket, top entry, high construction, without adapter 1)	CFV 24 LG29	29	MFV 24 LG32	32		
with lever and gasket, top entry, high construction, without adapter 1)					MFV 24 LG40	40

1) enclosure without adapter, threaded on the body, to be used only with a complete cable gland.

**CHV LG (CAV LG) and [CFV LG],
MHV LG (MAV LG) and [MFV LG]**

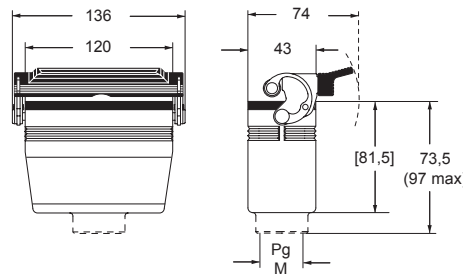

MFO 24 LG40

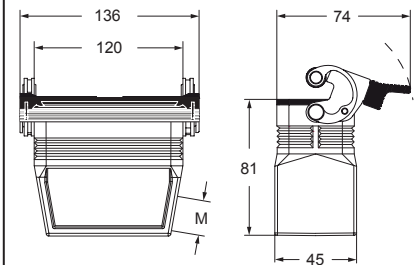

MFV 24 LG40

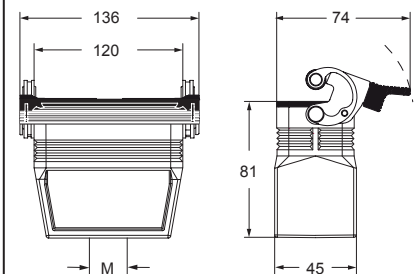

CAIUS® Type 4/4X/12

 insulating cable gland or fittings without gasket

 cable gland with O-Ring gasket

C-TYPE

CAN C-TYPE standard version

inserts		page:
CD	64 poles + ⊕	72
CDD	108 poles + ⊕	81
CDS	42 poles + ⊕	-
CDSH	42 poles + ⊕	89
CNE	24 poles + ⊕	113
CSE	24 poles + ⊕	-
CSH	24 poles + ⊕	113
CSH S	24 poles + ⊕	125
CCE	24 poles + ⊕	133
CMSH	10+2 (aux) poles + ⊕	140
CMCE	10+2 (aux) poles + ⊕	141
CSS	24 poles + ⊕	151
CQE	46 poles + ⊕	171
CQEE	64 poles + ⊕	177
CX	4/8 and 6/6 poles + ⊕	204 and 206
MIXO	6 modules	262 - 317

hoods for ribbon cable with 4 pegs



gaskets for ribbon cable hood



description	part No.	part No.
-------------	----------	----------

with pegs, top entry

CAN 24

ribbon cable seals (supplied separately)
 one slot for cable sizes 18,8 x 5,8 mm
 one slot for cable sizes 63,8 x 5,1 mm
 slot for cable sizes 36 x 9 mm
 not pre-drilled

CRN 1
CRN 2
CRN 3
CRN P

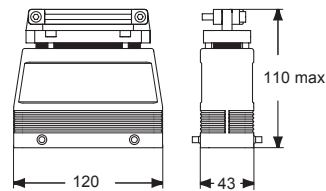

CAVUS® Type 4/4X/12



C-TYPE

CH - CA and MH - MA C-TYPE standard version

inserts		page:
CD	64 poles + ⊕	72
CDD	108 poles + ⊕	81
CDS	42 poles + ⊕	-
CDSH	42 poles + ⊕	89
CNE	24 poles + ⊕	113
CSE	24 poles + ⊕	-
CSH	24 poles + ⊕	113
CSH S	24 poles + ⊕	125
CCE	24 poles + ⊕	133
CMSH	10+2 (aux) poles + ⊕	140
CMCE	10+2 (aux) poles + ⊕	141
CSS	24 poles + ⊕	151
CQE	46 poles + ⊕	171
CQEE	64 poles + ⊕	177
CX	4/8 and 6/6 poles + ⊕	204 and 206
MIXO	6 modules	262 - 317

hoods with 2 levers

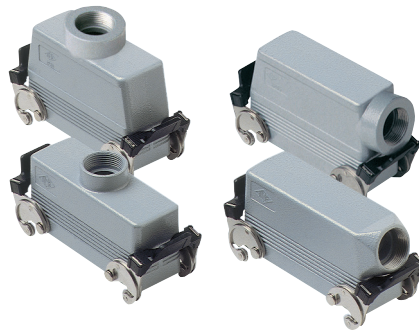

covers

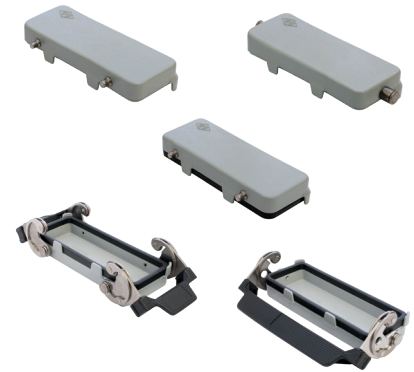

description	part No.	entry Pg	part No.	entry M	part No. (with eyelet)	part No. (with loop)
with levers, side entry ¹⁾	CHO 24 X	21	MHO 24 X25	25		
with levers, side entry ¹⁾			MHO 24 X32	32		
with levers, side entry, high construction ¹⁾	CAO 24 X	21	MAO 24 X32	32		
with levers, side entry, high construction ¹⁾	CAO 24 X29	29	MAO 24 X40	40		
with levers, top entry ¹⁾	CHV 24 X	21				
with levers, top entry ^{1) 3)}			MHV 24 X25	25		
with levers, top entry ¹⁾			MHV 24 X32	32		
with levers, top entry, high construction ¹⁾	CAV 24 X	21	MAV 24 X32	32		
with levers, top entry, high construction ¹⁾	CAV 24 X29	29	MAV 24 X40	40		
with 4 pegs (for enclosures with 2 levers with gasket)					CHC 24	CHC 24 S
with 4 pegs and gasket (for enclosures with 2 levers) ²⁾						CHC 24 C
with 2 pegs (for enclosures with 1 lever with gasket)					CHC 24 L	CHC 24 SL
with 2 levers (for hoods with 4 pegs)						CHC 24 G
with 1 lever (for hoods with 2 pegs)						CHC 24 LG

¹⁾ may be combined with enclosures:
 - CHI/CHP/CAP 24 CS/CP/C
 - MHP/MAP 24 CS/CP

²⁾ may be combined with enclosures:
 - CHO/CAO 24 X and CHV/CAV 24 X
 - MHO/MAO 24 X and MHV/MAV 24 X

³⁾ can only be used with a complete cable gland (to be purchased separately).

CHO X (CAO X) and MHO X (MAO X)

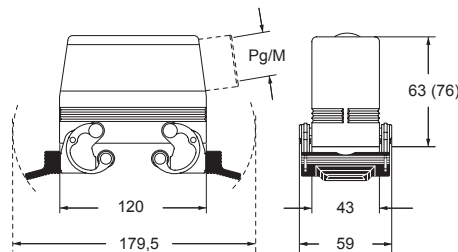

CHV X (CAV X) and MHV X (MAV X)

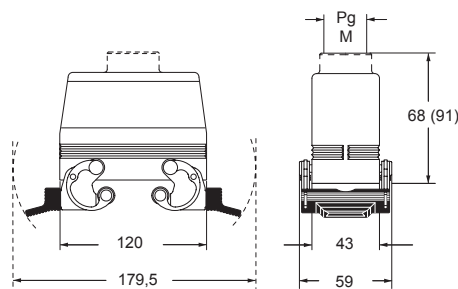

CHC (S)

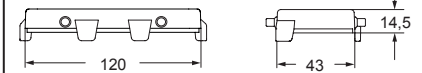

CHC C



CHC L (SL)

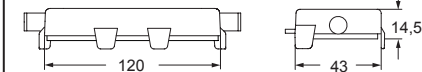

CHC G

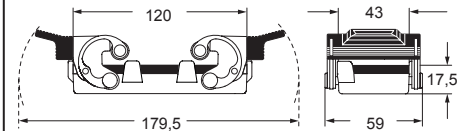

CHC LG

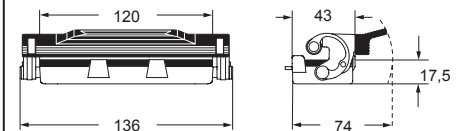

For fixing on housings

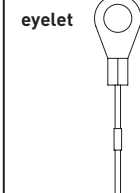

For fixing on hoods

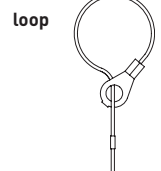

CAIUS® Type 4/4X/12



insulating cable gland or fittings without gasket



cable gland with O-Ring gasket

CAC C-TYPE standard version

inserts		page:
CD	64 poles + ⊕	72
CDD	108 poles + ⊕	81
CDS	42 poles + ⊕	-
CDSH	42 poles + ⊕	89
CNE	24 poles + ⊕	113
CSE	24 poles + ⊕	-
CSH	24 poles + ⊕	113
CSH S	24 poles + ⊕	125
CCE	24 poles + ⊕	133
CMSH	10+2 (aux) poles + ⊕	140
CMCE	10+2 (aux) poles + ⊕	141
CSS	24 poles + ⊕	151
CQE	46 poles + ⊕	171
CQEE	64 poles + ⊕	177
CX	4/8 and 6/6 poles + ⊕	204 and 206
MIXO	6 modules	262 - 317

hoods without entry, to be drilled



hoods without entry, to be drilled



description	part No. with 4 pegs	part No. with 2 pegs
-------------	-------------------------	-------------------------

with pegs, high construction

CAC 24

CAC 24 L

Alternatively, hoods with pegs may be coupled with fixed enclosures:

- C-TYPE, IP65 or IP66/IP69 stainless steel lever, from page 412 to page 422
- C7, IP66/IP67/IP69 stainless steel lever, page 441
- CV, IP65 or IP66/IP69 stainless steel lever, page 460 and 461

CAC 24 ●

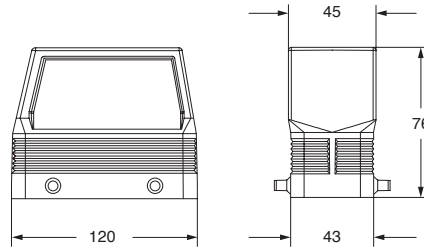

CAC 24 L ▲

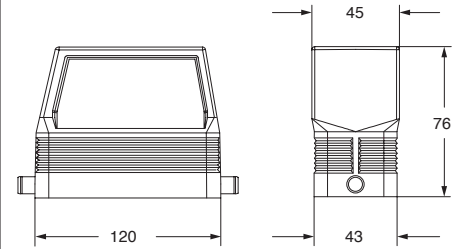

CAI[®] US Type 4/4X/12



● IP67 if coupled with IP67 housings