

# CH C-TYPE standard version

inserts		page:
CDD	42 poles + ⊕	78
CDS	18 poles + ⊕	-
CDSH	18 poles + ⊕	87
CNE	10 poles + ⊕	111
CSE	10 poles + ⊕	-
CSH	10 poles + ⊕	111
CSH S	10 poles + ⊕	123
CCE	10 poles + ⊕	131
CMSH	3+2 (aux) poles + ⊕	136
CMCE	3+2 (aux) poles + ⊕	137
CSS	10 poles + ⊕	149
CT, CTSE (16A) *)	10 poles + ⊕	161
CQE	18 poles + ⊕	169
CX	8/24 poles + ⊕	194
MIXO	3 modules	262 - 317

\*) can be used only in bulkhead mounting housings

## bulkhead mounting housings with 2 levers or 4 pegs



## bulkhead mounting housings with single lever



description	part No.	part No.
with one or two levers	<b>CHI 10</b>	<b>CHI 10 L</b>
with pegs 1)	<b>CHI 10 C</b>	
with pegs and aluminum cover 1)	<b>CHI 10 CS</b>	
with pegs and plastic cover 1)	<b>CHI 10 CP</b>	
with lever and cover		<b>CHI 10 LS</b>

1) may be combined with enclosures:  
 - CHO/CAO 10 X and CHV/CAV 10 X  
 - MHO/MAO 10 X and MHV/MAV 10 X

panel cut-out for bulkhead mounting housings

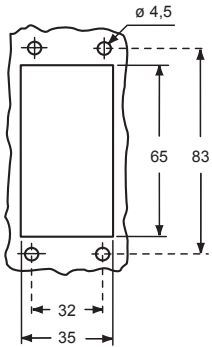

**IMPORTANT NOTE:** The enclosures ensure IP66/IP69 degree of protection (or IP65 for hinged cover versions) when mated and locked with the closing levers. The cover (CS, CP) only ensures mechanical protection, but does not ensure IP65 degree of protection.

**CR CLK**  
locking device for CLASS locking levers (page 666)



### CHI ▲

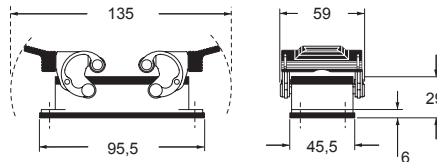

### CHI C ▲

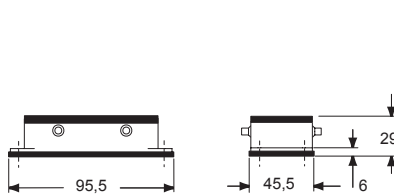

### CHI CS/CP ●

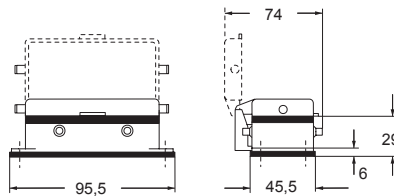

### CHI L ▲

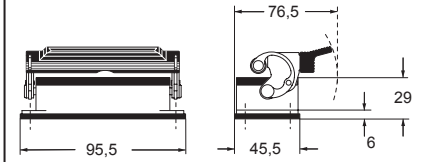

### CHI LS ●

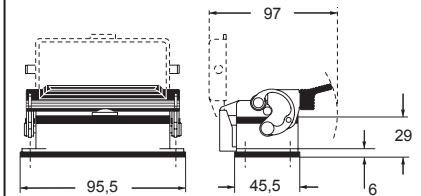

**ANGLED VERSION**  
(page 450)



**CRUS**® Type 4/4X/12  
(except enclosures with plastic cover)



# CH - CA and MH - MA C-TYPE standard version

inserts		page:
CDD	42 poles + ⊕	78
CDS	18 poles + ⊕	-
CDSH	18 poles + ⊕	87
CNE	10 poles + ⊕	111
CSE	10 poles + ⊕	-
CSH	10 poles + ⊕	111
CSH S	10 poles + ⊕	123
CCE	10 poles + ⊕	131
CMSH	3+2 (aux) poles + ⊕	136
CMCE	3+2 (aux) poles + ⊕	137
CSS	10 poles + ⊕	149
CQE	18 poles + ⊕	169
CX	8/24 poles + ⊕	194
MIXO	3 modules	262 - 317

## surface mounting housings with 2 levers or 4 pegs



## surface mounting housings with single lever



description	part No.	entry Pg	part No.	entry M	part No.	entry Pg	part No.	entry M
with lever/s	<b>CHP 10</b>	16	<b>MHP 10.20</b>	20	<b>CHP 10 L</b>	16	<b>MHP 10 L20</b>	20
with lever/s	<b>CHP 10.2</b>	16 x 2	<b>MHP 10.220</b>	20 x 2	<b>CHP 10 L2</b>	16 x 2	<b>MHP 10 L220</b>	20 x 2
with levers, high construction 1)			<b>MAP 10.25</b>	25				
with levers, high construction 1)			<b>MAP 10.225</b>	25 x 2				
with lever/s, high construction	<b>CAP 10.21</b>	21	<b>MAP 10.32</b>	32	<b>CAP 10 L</b>	21	<b>MAP 10 L32</b>	32
with lever/s, high construction	<b>CAP 10.221</b>	21 x 2	<b>MAP 10.232</b>	32 x 2	<b>CAP 10 L2</b>	21 x 2	<b>MAP 10 L232</b>	32 x 2
with lever/s, high construction	<b>CAP 10.29</b>	29	<b>MAP 10.40</b>	40	<b>CAP 10 L29</b>	29	<b>MAP 10 L40</b>	40
with lever/s, high construction	<b>CAP 10.229</b>	29 x 2	<b>MAP 10.240</b>	40 x 2	<b>CAP 10 L229</b>	29 x 2	<b>MAP 10 L240</b>	40 x 2
with pegs and aluminum cover 2)	<b>CHP 10 CS</b>	16	<b>MHP 10 CS20</b>	20				
with pegs and aluminum cover 2)	<b>CHP 10 CS2</b>	16 x 2	<b>MHP 10 CS220</b>	20 x 2				
with pegs and aluminum cover, high construction 2)	<b>CAP 10 CS</b>	21	<b>MAP 10 CS32</b>	32				
with pegs and aluminum cover, high construction 2)	<b>CAP 10 CS2</b>	21 x 2	<b>MAP 10 CS232</b>	32 x 2				
with pegs and aluminum cover, high construction 2)	<b>CAP 10 CS29</b>	29	<b>MAP 10 CS40</b>	40				
with pegs and aluminum cover, high construction 2)	<b>CAP 10 CS229</b>	29 x 2	<b>MAP 10 CS240</b>	40 x 2				
with pegs and plastic cover 2)	<b>CHP 10 CP</b>	16	<b>MHP 10 CP20</b>	20				
with pegs and plastic cover 2)	<b>CHP 10 CP2</b>	16 x 2	<b>MHP 10 CP220</b>	20 x 2				
with pegs and plastic cover, high construction 2)	<b>CAP 10 CP</b>	21	<b>MAP 10 CP32</b>	32				
with pegs and plastic cover, high construction 2)	<b>CAP 10 CP2</b>	21 x 2	<b>MAP 10 CP232</b>	32 x 2				
with pegs and plastic cover, high construction 2)	<b>CAP 10 CP29</b>	29	<b>MAP 10 CP40</b>	40				
with pegs and plastic cover, high construction 2)	<b>CAP 10 CP229</b>	29 x 2	<b>MAP 10 CP240</b>	40 x 2				
with lever and aluminium cover	<b>CHP 10 LS</b>	16	<b>MHP 10 LS20</b>	20				
with lever and aluminium cover	<b>CHP 10 LS2</b>	16 x 2	<b>MHP 10 LS220</b>	20 x 2				
with lever and aluminium cover, high construction	<b>CAP 10 LS</b>	21	<b>MAP 10 LS32</b>	32				
with lever and aluminium cover, high construction	<b>CAP 10 LS2</b>	21 x 2	<b>MAP 10 LS232</b>	32 x 2				
with lever and aluminium cover, high construction	<b>CAP 10 LS29</b>	29	<b>MAP 10 LS40</b>	40				
with lever and aluminium cover, high construction	<b>CAP 10 LS229</b>	29 x 2	<b>MAP 10 LS240</b>	40 x 2				

1) can only be used only with a complete cable gland (to be purchased separately)

2) may be combined with enclosures:  
 - CHO/CAO 10 X and CHV/CAV 10 X  
 - MHO/MAO 10 X and MHV/MAV 10 X

**IMPORTANT NOTE:** The enclosures ensure IP66/IP69 degree of protection (or IP65 for hinged cover versions) when mated and locked with the closing levers. The cover (CS, CP) only ensures mechanical protection, but does not ensure IP65 degree of protection.

**CR CLK**  
locking device for CLASS locking levers (page 666)



**CRUS** Type 4/4X/12  
(except enclosures with plastic cover)



insulating cable gland or fittings without gasket



cable gland with O-Ring gasket

### CHP - CAP and MHP - MAP ▲

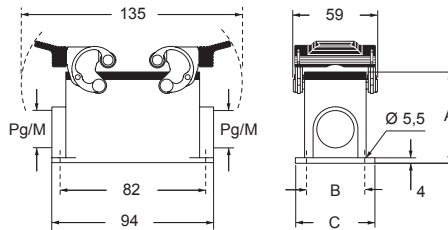

### CHP CS/CP - CAP CS/CP and MHP CS/CP - MAP CS/CP ●

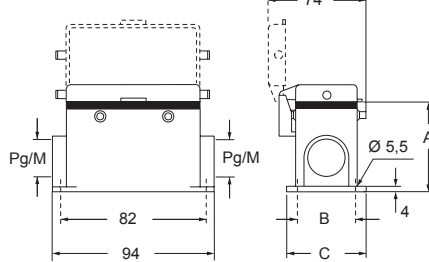

type	A	B	C
CHP / MHP	57	40	52
CAP / MAP	74	45	57
CHP CS / MHP CS	57	40	52
CAP CS / MAP CS	74	45	57
CHP CP / MHP CP	57	40	52
CAP CP / MAP CP	74	45	57

### CHP L - CAP L and MHP L - MAP L ▲

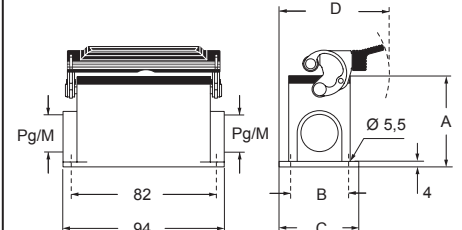

### CHP LS - CAP LS and MHP LS - MAP LS ●

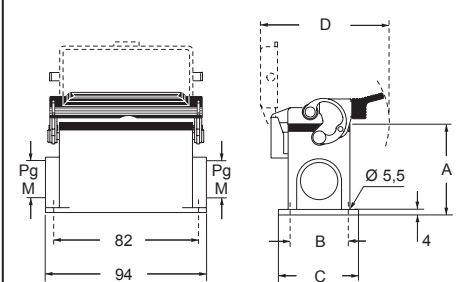

type	A	B	C	D
CHP L / MHP L	57	40	52	79,5
CAP L / MAP L	74	45	57	82
CHP LS / MHP LS	57	40	52	97
CAP LS / MAP LS	74	45	57	97

# CH - CA - CF and MH - MA - MF C-TYPE standard version

inserts		page:
CDD	42 poles + ⊕	78
CDS	18 poles + ⊕	-
CDSH	18 poles + ⊕	87
CNE	10 poles + ⊕	111
CSE	10 poles + ⊕	-
CSH	10 poles + ⊕	111
CSH S	10 poles + ⊕	123
CCE	10 poles + ⊕	131
CMSH	3+2 (aux) poles + ⊕	136
CMCE	3+2 (aux) poles + ⊕	137
CSS	10 poles + ⊕	149
CQE	18 poles + ⊕	169
CX	8/24 poles + ⊕	194
MIXO	3 modules	262 - 317

## hoods with 4 pegs



## hoods with 4 pegs

M40 cable entry with 20 mm thread length



description	part No.	entry Pg	part No.	entry M	part No.	entry Pg	part No.	entry M
with pegs, side entry	<b>CHO 10</b>	16	<b>MHO 10.20</b>	20				
with pegs, side entry			<b>MHO 10.25</b>	25				
with pegs, side entry, high construction	<b>CAO 10.21</b>	21	<b>MAO 10.32</b>	32				
with pegs, side entry, high construction	<b>CAO 10.29</b>	29	<b>MAO 10.40</b>	40				
with pegs, side entry, high construction, without adapter <sup>1)</sup>					<b>CFO 10.21</b>	21	<b>MFO 10.32</b>	32
with pegs, side entry, high construction, without adapter <sup>1)</sup>					<b>CFO 10.29</b>	29	<b>MFO 10.40</b>	40
with pegs, top entry	<b>CHV 10</b>	16						
with pegs, top entry <sup>2)</sup>			<b>MHV 10.20</b>	20				
with pegs, top entry			<b>MHV 10.25</b>	25				
with pegs, top entry, high construction	<b>CAV 10.21</b>	21	<b>MAV 10.32</b>	32				
with pegs, top entry, high construction	<b>CAV 10.29</b>	29	<b>MAV 10.40</b>	40				
with pegs, top entry, high construction, without adapter <sup>1)</sup>					<b>CFV 10.21</b>	21	<b>MFV 10.32</b>	32
with pegs, top entry, high construction, without adapter <sup>1)</sup>					<b>CFV 10.29</b>	29	<b>MFV 10.40</b>	40
with pegs, frontal entry, high construction	<b>CAF 10</b>	16	<b>MAF 10.20</b>	20				
with pegs, frontal entry, high construction, without adapter <sup>1)</sup>	<b>CFF 10</b>	16	<b>MFF 10.20</b>	20				

<sup>1)</sup> enclosure without adapter, threaded on the body, to be used only with a complete cable gland.

<sup>2)</sup> can only be used with a complete cable gland (to be purchased separately).

IP degrees are according to the type of lever of the counterpart enclosures.

Alternatively, hoods with pegs may be coupled with fixed enclosures:

- C-TYPE, IP65 or IP66/IP69 stainless steel lever, from page 393 to page 400
- C7, IP66/IP67/IP69 stainless steel lever, page 438
- CV, IP65 or IP66/IP69 stainless steel lever, page 448 and 449

### CHO (CAO) and MHO (MAO)

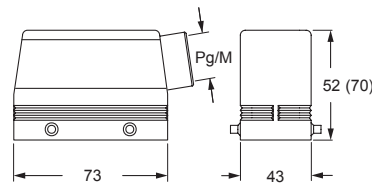

### CFO and MFO

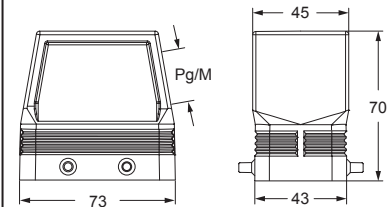

### CHV (CAV) and MHV (MAV)

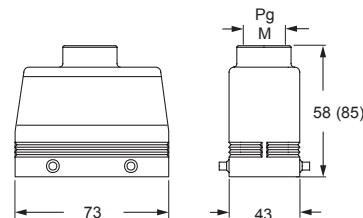

### CFV and MFV

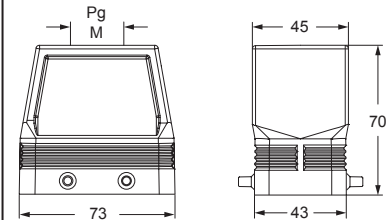

### CAF/CFF and MAF/MFF

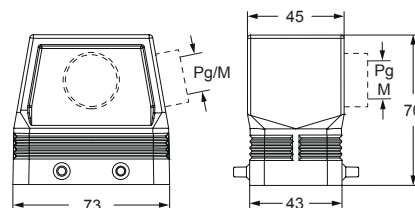

**CALUS**® Type 4/4X/12

insulating cable gland or fittings without gasket

cable gland with O-Ring gasket  
IP67 if hoods without adapters coupled with IP67 housings

**CH - CA - CF and MH - MA - MF C-TYPE standard version**

inserts		page:
CDD	42 poles + ⊕	78
CDS	18 poles + ⊕	-
CDSH	18 poles + ⊕	87
CNE	10 poles + ⊕	111
CSE	10 poles + ⊕	-
CSH	10 poles + ⊕	111
CSH S	10 poles + ⊕	123
CCE	10 poles + ⊕	131
CMSH	3+2 (aux) poles + ⊕	136
CMCE	3+2 (aux) poles + ⊕	137
CSS	10 poles + ⊕	149
CQE	18 poles + ⊕	169
CX	8/24 poles + ⊕	194
MIXO	3 modules	262 - 317

hoods with 2 pegs



hoods with 2 pegs  
M40 cable entry with 20 mm thread length



description	part No.	entry Pg	part No.	entry M	part No.	entry Pg	part No.	entry M
with pegs, side entry	<b>CHO 10 L</b>	16	<b>MHO 10 L20</b>	20				
with pegs, side entry			<b>MHO 10 L25</b>	25				
with pegs, side entry, high construction	<b>CAO 10 L21</b>	21	<b>MAO 10 L32</b>	32				
with pegs, side entry, high construction	<b>CAO 10 L29</b>	29	<b>MAO 10 L40</b>	40				
with pegs, side entry, high construction, without adapter 1)					<b>CFO 10 L21</b>	21	<b>MFO 10 L32</b>	32
with pegs, side entry, high construction, without adapter 1)					<b>CFO 10 L29</b>	29	<b>MFO 10 L40</b>	40
with pegs, top entry	<b>CHV 10 L</b>	16						
with pegs, top entry 2)			<b>MHV 10 L20</b>	20				
with pegs, top entry			<b>MHV 10 L25</b>	25				
with pegs, top entry, high construction	<b>CAV 10 L21</b>	21	<b>MAV 10 L32</b>	32				
with pegs, top entry, high construction	<b>CAV 10 L29</b>	29	<b>MAV 10 L40</b>	40				
with pegs, top entry, high construction, without adapter 1)					<b>CFV 10 L21</b>	21	<b>MFV 10 L32</b>	32
with pegs, top entry, high construction, without adapter 1)					<b>CFV 10 L29</b>	29	<b>MFV 10 L40</b>	40

1) enclosure without adapter, threaded on the body, to be used only with a complete cable gland.

2) can only be used with a complete cable gland (to be purchased separately).

IP degrees are according to the type of lever of the counterpart enclosures. Alternatively, hoods with pegs may be coupled with fixed enclosures:

- C-TYPE, IP65 or IP66/IP69 stainless steel lever, from page 393 to page 400
- CV, IP65 or IP66/IP69 stainless steel lever, page 448 and 449

**CHO L (CAO L) and MHO L (MAO L)**

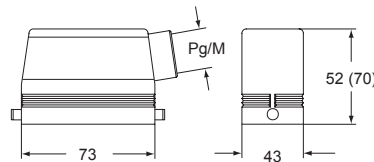

**CHV L (CAV L) and MHV L (MAV L)**

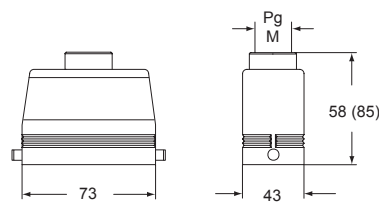

**CFO L and MFO L**

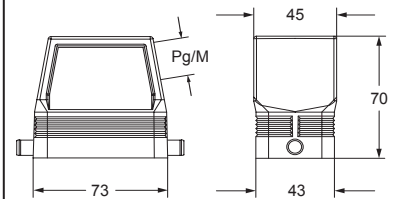

**CFV L and MFV L**

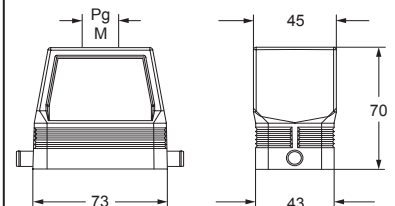

**CALUS**® Type 4/4X/12

 insulating cable gland or fittings without gasket

 cable gland with O-Ring gasket

# CH - CF and MA - MF C-TYPE standard version

inserts		page:
CDD	42 poles + ⊕	78
CDS	18 poles + ⊕	-
CDSH	18 poles + ⊕	87
CNE	10 poles + ⊕	111
CSE	10 poles + ⊕	-
CSH	10 poles + ⊕	111
CSH S	10 poles + ⊕	123
CCE	10 poles + ⊕	131
CMSH	3+2 (aux) poles + ⊕	136
CMCE	3+2 (aux) poles + ⊕	137
CSS	10 poles + ⊕	149
CQE	18 poles + ⊕	169
CX	8/24 poles + ⊕	194
MIXO	3 modules	262 - 317

## hoods with double top entry



description	part No.	entry Pg	part No.	entry M
with pegs for two levers used with enclosures size "57.27"	<b>CAV 10.213</b>	13,5 x 2	<b>MAV 10.220</b>	20 x 2
with pegs for two levers, without adapter 1) used with enclosures size "57.27"	<b>CFV 10.213</b>	13,5 x 2	<b>MFV 10.220</b>	20 x 2

1) enclosure without adapter, threaded on the body, to be used only with a complete cable gland.

IP degrees are according to the type of lever of the counterpart enclosures.

Alternatively, hoods with pegs may be coupled with fixed enclosures:

- C-TYPE, IP65 or IP66/IP69 stainless steel lever, from page 393 to page 400
- C7, IP66/**IP67**/IP69 stainless steel lever, page 438
- CV, IP65 or IP66/IP69 stainless steel lever, page 448 and 449

## CAV/CFV and MAV/MFV

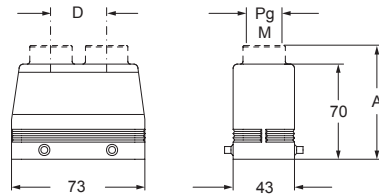

part No.	A	B
<b>CAV 10.213 - MAV 10.220</b>	82 (84,5)	26 (28,5)
<b>CFV 10.213 - MFV 10.220</b>	-	28,5 (26)

**CAV**® Type 4/4X/12



insulating cable gland or fittings without gasket



cable gland with O-Ring gasket  
IP67 if hoods without adapters coupled with IP67 housings

**CH - CA - CF and MH - MA - MF C-TYPE standard version**

inserts		page:
CDD	42 poles + ⊕	78
CDS	18 poles + ⊕	-
CDSH	18 poles + ⊕	87
CNE	10 poles + ⊕	111
CSE	10 poles + ⊕	-
CSH	10 poles + ⊕	111
CSH S	10 poles + ⊕	123
CCE	10 poles + ⊕	131
CMSH	3+2 (aux) poles + ⊕	136
CMCE	3+2 (aux) poles + ⊕	137
CSS	10 poles + ⊕	149
CQE	18 poles + ⊕	169
CX	8/24 poles + ⊕	194
MIXO	3 modules	262 - 317

**hoods with 2 levers**



**hoods with 2 levers  
M40 cable entry with 20 mm thread length**



description	part No.	entry Pg	part No.	entry M	part No.	entry M
with levers and gasket, side entry, high construction, without adapter 1)					<b>MFO 10 G40</b>	40
with levers and gasket, top entry	<b>CHV 10 G</b>	16	<b>MHV 10 G25</b>	25		
with levers and gasket, top entry, high construction	<b>CAV 10 G</b>	21	<b>MAV 10 G25</b>	25		
with levers and gasket, top entry, high construction	<b>CAV 10 G29</b>	29	<b>MAV 10 G32</b>	32		
with levers and gasket, top entry, high construction, without adapter 1)	<b>CFV 10 G</b>	21	<b>MFV 10 G25</b>	25		
with levers and gasket, top entry, high construction, without adapter 1)	<b>CFV 10 G29</b>	29	<b>MFV 10 G32</b>	32		
with levers and gasket, top entry, high construction, without adapter 1)					<b>MFV 10 G40</b>	40

1) enclosure without adapter, threaded on the body, to be used only with a complete cable gland.

**CHV G (CAV G) and [CFV G],  
MHV G (MAV G) and [MFV G]**

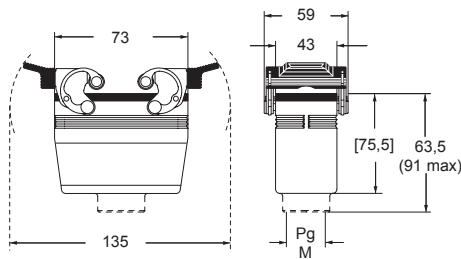

**MFO 10 G40**

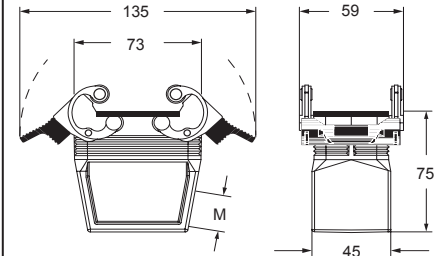

**MFV 10 G40**

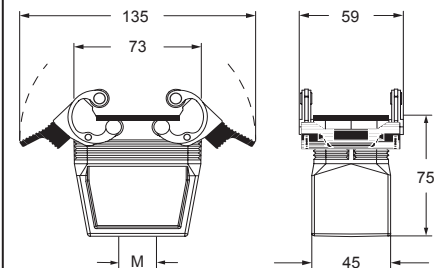

**CAIUS**® Type 4/4X/12

 insulating cable gland or fittings without gasket

 cable gland with O-Ring gasket

C-TYPE



# CH - CA - CF and MH - MA - MF C-TYPE standard version

inserts		page:
CDD	42 poles + ⊕	78
CDS	18 poles + ⊕	-
CDSH	18 poles + ⊕	87
CNE	10 poles + ⊕	111
CSE	10 poles + ⊕	-
CSH	10 poles + ⊕	111
CSH S	10 poles + ⊕	123
CCE	10 poles + ⊕	131
CMSH	3+2 (aux) poles + ⊕	136
CMCE	3+2 (aux) poles + ⊕	137
CSS	10 poles + ⊕	149
CQE	18 poles + ⊕	169
CX	8/24 poles + ⊕	194
MIXO	3 modules	262 - 317

## hoods with 1 lever



## hoods with 1 lever

M40 cable entry with 20 mm thread length



description	part No.	entry Pg	part No.	entry M	part No.	entry M
with lever and gasket, side entry, high construction, without adapter <sup>1)</sup>					<b>MFO 10 LG40</b>	40
with lever and gasket, top entry	<b>CHV 10 LG</b>	16	<b>MHV 10 LG25</b>	25		
with lever and gasket, top entry, high construction	<b>CAV 10 LG21</b>	21	<b>MAV 10 LG25</b>	25		
with lever and gasket, top entry, high construction	<b>CAV 10 LG29</b>	29	<b>MAV 10 LG32</b>	32		
with lever and gasket, top entry, high construction, without adapter <sup>1)</sup>	<b>CFV 10 LG21</b>	21	<b>MFV 10 LG25</b>	25		
with lever and gasket, top entry, high construction, without adapter <sup>1)</sup>	<b>CFV 10 LG29</b>	29	<b>MFV 10 LG32</b>	32		
with lever and gasket, top entry, high construction, without adapter <sup>1)</sup>					<b>MFV 10 LG40</b>	40

<sup>1)</sup> enclosure without adapter, threaded on the body, to be used only with a complete cable gland.

### CHV LG (CAV LG) and [CFV LG], MHV LG (MAV LG) and [MFV LG]

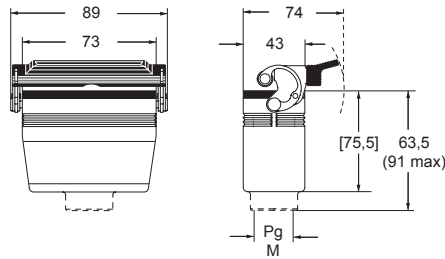

### MFO 10 LG40

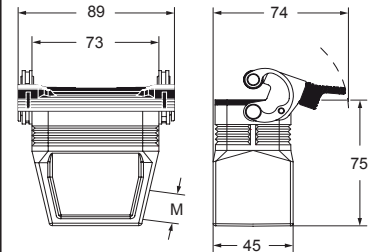

### MFV 10 LG40

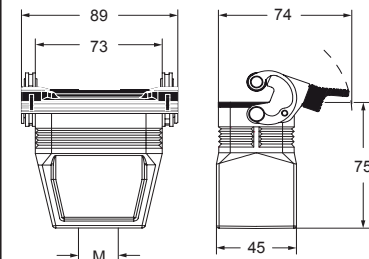

**CAVUS**® Type 4/4X/12

insulating cable gland or fittings without gasket

cable gland with O-Ring gasket

# CH - CA and MH - MA C-TYPE standard version

inserts		page:
CDD	42 poles + ⊕	78
CDS	18 poles + ⊕	-
CDSH	18 poles + ⊕	87
CNE	10 poles + ⊕	111
CSE	10 poles + ⊕	-
CSH	10 poles + ⊕	111
CSH S	10 poles + ⊕	123
CCE	10 poles + ⊕	131
CMSH	3+2 (aux) poles + ⊕	136
CMCE	3+2 (aux) poles + ⊕	137
CSS	10 poles + ⊕	149
CQE	18 poles + ⊕	169
CX	8/24 poles + ⊕	194
MIXO	3 modules	262 - 317

## hoods with 2 levers

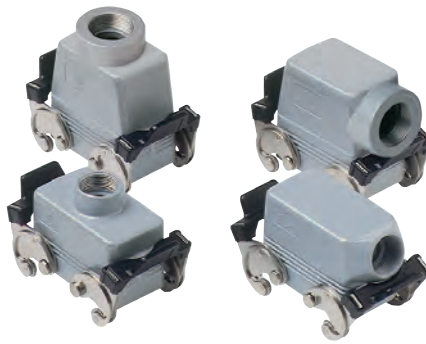

## covers



description	part No.	entry Pg	part No.	entry M	part No. (with eyelet)	part No. (with loop)
with levers, side entry <sup>1)</sup>	<b>CHO 10 X</b>	16	<b>MHO 10 X20</b>	20		
with levers, side entry <sup>1)</sup>			<b>MHO 10 X25</b>	25		
with levers, side entry, high construction <sup>1)</sup>	<b>CAO 10 X</b>	21	<b>MAO 10 X32</b>	32		
with levers, side entry, high construction <sup>1)</sup>	<b>CAO 10 X29</b>	29	<b>MAO 10 X40</b>	40		
with levers, top entry <sup>1)</sup>	<b>CHV 10 X</b>	16	<b>MHV 10 X20</b>	20		
with levers, top entry <sup>3)</sup>			<b>MHV 10 X25</b>	25		
with levers, top entry <sup>1)</sup>			<b>MAV 10 X32</b>	32		
with levers, top entry, high construction <sup>1)</sup>	<b>CAV 10 X</b>	21	<b>MAV 10 X40</b>	40		
with levers, top entry, high construction <sup>1)</sup>	<b>CAV 10 X29</b>	29				
with 4 pegs (for enclosures with 2 levers with gasket)					<b>CHC 10</b>	<b>CHC 10 S</b>
with 4 pegs and gasket (for enclosures with 2 levers) <sup>2)</sup>						<b>CHC 10 C</b>
with 2 pegs (for enclosures with 1 lever with gasket)					<b>CHC 10 L</b>	<b>CHC 10 SL</b>
with 2 levers (for hoods with 4 pegs)						<b>CHC 10 G</b>
with 1 lever (for hoods with 2 pegs)						<b>CHC 10 LG</b>

<sup>1)</sup> may be combined with enclosures:  
 - CHI/CHP/CAP 10 CS/CP/C  
 - MHP/MAP 10 CS/CP

<sup>2)</sup> may be combined with enclosures:  
 - CHO/CAO 10 X and CHV/CAV 10 X  
 - MHO/MAO 10 X and MHV/MAV 10 X

<sup>3)</sup> can only be used with a complete cable gland (to be purchased separately).

### CHO X (CAO X) and MHO X (MAO X)

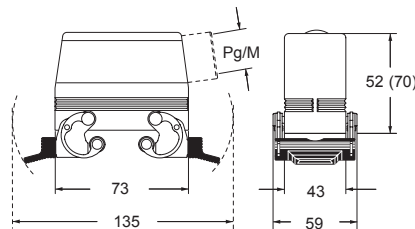

### CHV X (CAV X) and MHV X (MAV X)

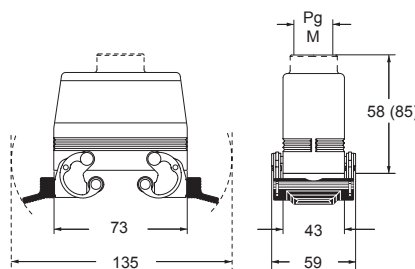

### CHC (S)

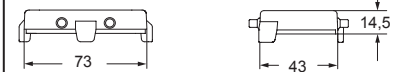

### CHC C



### CHC L (SL)



### CHC G

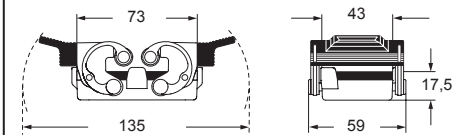

### CHC LG

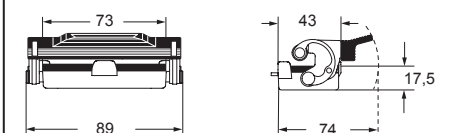

For fixing on housings

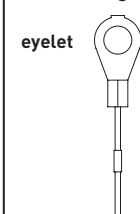

For fixing on hoods

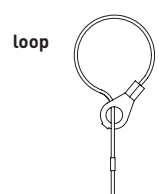

**CAIUS**® Type 4/4X/12



insulating cable gland or fittings without gasket



cable gland with O-Ring gasket



# CAC C-TYPE standard version

inserts		page:
CDD	42 poles + ⊕	78
CDS	18 poles + ⊕	-
CDSH	18 poles + ⊕	87
CNE	10 poles + ⊕	111
CSE	10 poles + ⊕	-
CSH	10 poles + ⊕	111
CSH S	10 poles + ⊕	123
CCE	10 poles + ⊕	131
CMSH	3+2 (aux) poles + ⊕	136
CMCE	3+2 (aux) poles + ⊕	137
CSS	10 poles + ⊕	149
CQE	18 poles + ⊕	169
CX	8/24 poles + ⊕	194
MIXO	3 modules	262 - 317

## hoods without entry, to be drilled



## hoods without entry, to be drilled



description	part No. (with 4 pegs)	part No. (with 2 pegs)
-------------	---------------------------	---------------------------

with pegs, high construction

**CAC 10**

**CAC 10 L**

Alternatively, hoods with pegs are coupled with fixed enclosures:  
 - C-TYPE, IP65 or IP66/IP69 stainless steel lever, from page 393 to page 400  
 - C7, IP66/IP67/IP69 stainless steel lever, page 438  
 - CV, IP65 or IP66/IP69 stainless steel lever, page 448 and 449

### CAC 10 ●

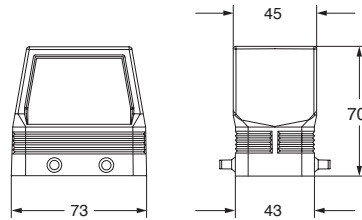

### CAC 10 L ▲

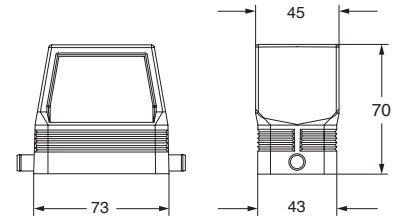

**CAI<sup>®</sup> US** Type 4/4X/12



● IP67 if coupled with IP67 housings