

- Compliant with EN 60309-1 and -2
- Enclosure, insert and locking ring in insulating, thermoplastic, self-extinguishing material
- Flange with anti-ageing gasket
- PE...SI types (IP44), RAL 7035 grey enclosure, plug mouth colour coded according to operating voltage
- PEW...SI (IP67) types, RAL 7035 grey enclosure, locking ring with gasket colour coded according to operating voltage
- Terminals with retained screws
- 63A, 125A: with pilot contact
- Nickel-plated contacts, available on request for 16A and 32A (standard on 63A and 125A)**
- IP44 and IP67 degrees of protection (EN 60529)
- With Italian Quality Mark

16A
IP44 degree of protection



32A
IP44 degree of protection



Number of poles	Frequency Hz	Voltage V	Earthing contact position h	Part No.	Colour	Part No.	Colour	
2P+⊕	50 and 60	100 - 130	4	PE 1643 SI		PE 3243 SI		
	50 and 60	200 - 250	9	PE 1663 SI		PE 3263 SI		
	50 and 60	380 - 415	6	PE 1693 SI		PE 3293 SI		
	50 and 60	480 - 500	7	PE 1673 SI		PE 3273 SI		
	50 and 60	ins. transformer	12	PE 16123 SI	A.V.	PE 32123 SI	A.V.	
	> 300 - 500	> 50	2	PE 1623 SI		PE 3223 SI		
	d.c.	> 50 - 250	3	PE 1633 SI	A.V.	PE 3233 SI	A.V.	
	d.c.	> 250	8	PE 1683 SI	A.V.	PE 3283 SI	A.V.	
	3P+⊕	50 and 60	100 - 130	4	PE 1644 SI		PE 3244 SI	
		50 and 60	200 - 250	9	PE 1694 SI		PE 3294 SI	
50 and 60		380 - 415	6	PE 1664 SI		PE 3264 SI		
60		440 - 460	11	PE 16114 SI		PE 32114 SI		
50 and 60		480 - 500	7	PE 1674 SI		PE 3274 SI		
50 and 60		600 - 690	5	PE 1654 SI		PE 3254 SI		
50		380	3	PE 1634 SI		PE 3234 SI		
60		440	3	PE 1634 SI		PE 3234 SI		
100 - 300		> 50	10	PE 16104 SI		PE 32104 SI		
> 300 - 500		> 50	2	PE 1624 SI		PE 3224 SI		
3P+N+⊕	50 and 60	57/100 - 75/130	4	PE 1645 SI		PE 3245 SI		
	50 and 60	120/208 - 144/250	9	PE 1695 SI		PE 3295 SI		
	50 and 60	200/346 - 240/415	6	PE 1665 SI		PE 3265 SI		
	50 and 60	277/480 - 288/500	7	PE 1675 SI		PE 3275 SI		
	50 and 60	347/600 - 400/690	5	PE 1655 SI		PE 3255 SI		
	60	250/440 - 265/460	11	PE 16115 SI		PE 32115 SI		
	50	220/380	3	PE 1635 SI		PE 3235 SI		
	60	250/440	3	PE 1635 SI		PE 3235 SI		
	> 300 - 500	> 50	2	PE 1625 SI		PE 3225 SI		

Legend

A.V. = Colour according to voltage

(*) Green may be used together with the colour of the operating range for frequencies above 60 Hz and up to a maximum of 500 Hz.

(**) For the code of products with nickel-plated contacts (socket holes, plug pins), add "N" to the pre-code of the corresponding standard product code; for example: PE becomes PEN and PEW becomes PEWN.

Accessories for IP67 plugs (optional)



Loose protective cover

Size	Polarity	Part No.
16A	2P+⊕	PEW 163 CS
16A	3P+⊕	PEW 164 CS
16A	3P+N+⊕	PEW 165 CS
32A	2/3P+⊕	PEW 324 CS
32A	3P+N+⊕	PEW 325 CS
63A	All	PEW 63 CS
125A	All	PEW 125 CS

Dimensions indicated are not binding and may be changed without prior notice.

Dimensions in mm

(16 / 32A) PE ... SI

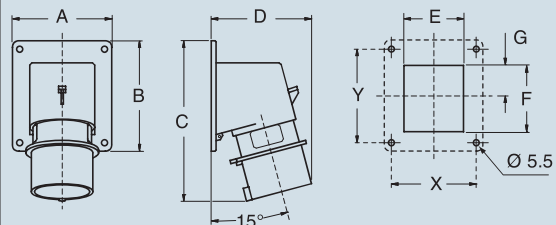

PE...SI	A	B	C	D	E	F	G	X	Y	
16A	2P+⊕	65	82	126	81	41	43	21.5	52	60
	3P+⊕	65	82	126	81	47	43	21.5	52	60
	3P+N+⊕	90	100	146	93	54	60	27.5	77	85
32A	2P+⊕	90	100	160	101	55	60	27.5	77	85
	3P+⊕	90	100	160	101	55	60	27.5	77	85
	3P+N+⊕	90	100	160	106	62	60	27.5	77	85

PEW flush-mounting plugs, low voltage from over 50V up to 690V



16A
IP67 degree of protection



32A
IP67 degree of protection



63A
IP67 degree of protection



125A
IP67 degree of protection



Part No.	Colour	Part No.	Colour	Part No.	Colour	Part No.	Colour
PEW 1643 SI ⊕	Yellow	PEW 3243 SI ⊕	Yellow	PEW 6343 SI ⊕	Yellow	PEW 12543 SI ⊕	Yellow
PEW 1663 SI ⊕	Blue	PEW 3263 SI ⊕	Blue	PEW 6363 SI ⊕	Blue	PEW 12563 SI ⊕	Blue
PEW 1693 SI ⊕	Red	PEW 3293 SI ⊕	Red	PEW 6393 SI ⊕	Red	PEW 12593 SI ⊕	Red
PEW 1673 SI ⊕	Black	PEW 3273 SI ⊕	Black	PEW 6373 SI ⊕	Black	PEW 12573 SI ⊕	Black
PEW 16123 SI ⊕	A.V.	PEW 32123 SI ⊕	A.V.	PEW 63123 SI ⊕	A.V.	PEW 125123 SI ⊕	A.V.
PEW 1623 SI ⊕	(+)	PEW 3223 SI ⊕	(+)				
PEW 1633 SI ⊕	A.V.	PEW 3233 SI	A.V.	PEW 6333 SI	A.V.	PEW 12533 SI	A.V.
PEW 1683 SI	A.V.	PEW 3283 SI	A.V.	PEW 6383 SI	A.V.	PEW 12583 SI	A.V.
PEW 1644 SI ⊕	Yellow	PEW 3244 SI ⊕	Yellow	PEW 6344 SI ⊕	Yellow	PEW 12544 SI ⊕	Yellow
PEW 1694 SI ⊕	Blue	PEW 3294 SI ⊕	Blue	PEW 6394 SI ⊕	Blue	PEW 12594 SI ⊕	Blue
PEW 1664 SI ⊕	Red	PEW 3264 SI ⊕	Red	PEW 6364 SI ⊕	Red	PEW 12564 SI ⊕	Red
PEW 16114 SI ⊕	Red	PEW 32114 SI ⊕	Red	PEW 63114 SI ⊕	Red	PEW 125114 SI ⊕	Red
PEW 1674 SI ⊕	Black	PEW 3274 SI ⊕	Black	PEW 6374 SI ⊕	Black	PEW 12574 SI ⊕	Black
PEW 1654 SI	Black	PEW 3254 SI	Black	PEW 6354 SI	Black	PEW 12554 SI	Black
PEW 1634 SI ⊕	Red	PEW 3234 SI ⊕	Red				
PEW 1634 SI ⊕	Red	PEW 3234 SI ⊕	Red				
PEW 16104 SI ⊕	(+)	PEW 32104 SI ⊕	(+)				
PEW 1624 SI ⊕	(+)	PEW 3224 SI ⊕	(+)				
PEW 1645 SI ⊕	Yellow	PEW 3245 SI ⊕	Yellow	PEW 6345 SI ⊕	Yellow	PEW 12545 SI ⊕	Yellow
PEW 1695 SI ⊕	Blue	PEW 3295 SI ⊕	Blue	PEW 6395 SI ⊕	Blue	PEW 12595 SI ⊕	Blue
PEW 1665 SI ⊕	Red	PEW 3265 SI ⊕	Red	PEW 6365 SI ⊕	Red	PEW 12565 SI ⊕	Red
PEW 1675 SI ⊕	Black	PEW 3275 SI ⊕	Black	PEW 6375 SI ⊕	Black	PEW 12575 SI ⊕	Black
PEW 1655 SI	Black	PEW 3255 SI	Black	PEW 6355 SI	Black	PEW 12555 SI	Black
PEW 16115 SI ⊕	Red	PEW 32115 SI ⊕	Red	PEW 63115 SI ⊕	Red	PEW 125115 SI ⊕	Red
PEW 1635 SI ⊕	Red	PEW 3235 SI ⊕	Red				
PEW 1635 SI ⊕	Red	PEW 3235 SI ⊕	Red				
PEW 1625 SI ⊕	(+)	PEW 3225 SI ⊕	(+)				

Dimensions in mm

(16 / 32A) PEW ... SI

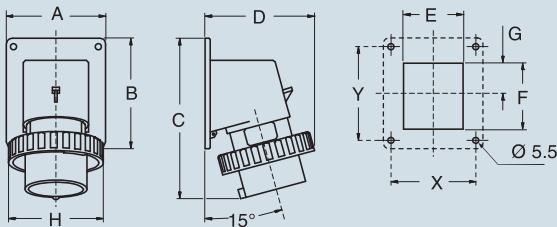

PEW...SI	A	B	C	D	E	F	G	H	X	Y
16A 2P+⊕	65	82	126	81	41	43	21.5	70	52	60
3P+⊕	65	82	126	81	47	43	24.5	78	52	60
3P+N+⊕	90	100	146	93	54	60	27.5	86	77	85
32A 2P+⊕	90	100	160	101	55	60	27.5	92	77	85
3P+⊕	90	100	160	101	55	60	27.5	92	77	85
3P+N+⊕	90	100	160	101	62	60	27.5	100	77	85

Dimensions in mm

(63A) PEW ... SI

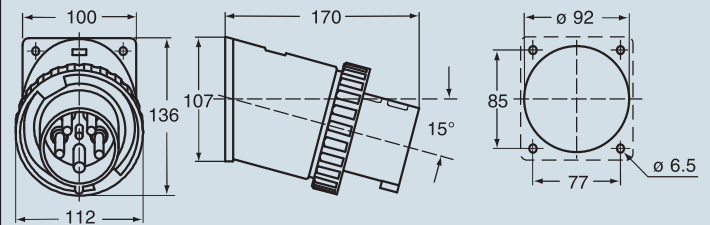

(125A) PEW ... SI

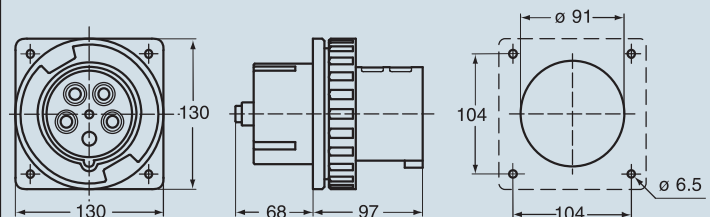

PEW...SI