

- Compliant with EN 60309-1 and -2
- Enclosure, insert and spring lid in insulating, thermoplastic, self-extinguishing material
- RAL 7035 grey enclosure, spring lid colour coded according to the operating voltage
- Flange with anti-ageing gasket
- PE...PQ types (IP44), spring lid
- PEW...PQ types (IP67), spring lid with locking ring and gasket
- Terminals with retained screws
- 63A, 125A: with pilot contact
- Nickel-plated contacts, available on request for 16A and 32A (standard on 63A and 125A)**
- IP44 and IP67 degrees of protection (EN 60529)
- With Italian Quality Mark

16A
IP44 degree of protection



32A
IP44 degree of protection



Poles	Frequency Hz	Voltage V	Earthing contact position h	Part No.	Colour	Part No.	Colour
2P+	50 and 60	100 - 130	4	PE 1643 PQ		PE 3243 PQ	
	50 and 60	200 - 250	6	PE 1663 PQ		PE 3263 PQ	
	50 and 60	380 - 415	9	PE 1693 PQ		PE 3293 PQ	
	50 and 60	480 - 500	7	PE 1673 PQ		PE 3273 PQ	
	50 and 60	ins. transformer	12	PE 16123 PQ	A.V.	PE 32123 PQ	A.V.
	> 300 - 500	> 50	2	PE 1623 PQ		PE 3223 PQ	
	d.c.	> 50 - 250	3	PE 1633 PQ	A.V.	PE 3233 PQ	A.V.
	d.c.	> 250	8	PE 1683 PQ	A.V.	PE 3283 PQ	A.V.
	3P+	50 and 60	100 - 130	4	PE 1644 PQ		PE 3244 PQ
50 and 60		200 - 250	9	PE 1694 PQ		PE 3294 PQ	
50 and 60		380 - 415	6	PE 1664 PQ		PE 3264 PQ	
60		440 - 460	11	PE 16114 PQ		PE 32114 PQ	
50 and 60		480 - 500	7	PE 1674 PQ		PE 3274 PQ	
50 and 60		600 - 690	5	PE 1654 PQ		PE 3254 PQ	
50		380	3	PE 1634 PQ		PE 3234 PQ	
60		440	3	PE 1634 PQ		PE 3234 PQ	
100 - 300		> 50	10	PE 16104 PQ		PE 32104 PQ	
> 300 - 500		> 50	2	PE 1624 PQ		PE 3224 PQ	
3P+N+		50 and 60	57/100 - 75/130	4	PE 1645 PQ		PE 3245 PQ
	50 and 60	120/208 - 144/250	9	PE 1695 PQ		PE 3295 PQ	
	50 and 60	200/346 - 240/415	6	PE 1665 PQ		PE 3265 PQ	
	50 and 60	277/480 - 288/500	7	PE 1675 PQ		PE 3275 PQ	
	50 and 60	347/600 - 400/690	5	PE 1655 PQ		PE 3255 PQ	
	60	250/440 - 265/460	11	PE 16115 PQ		PE 32115 PQ	
	50	220/380	3	PE 1635 PQ		PE 3235 PQ	
	60	250/440	3	PE 1635 PQ		PE 3235 PQ	
	> 300 - 500	> 50	2	PE 1625 PQ		PE 3225 PQ	

Legend

A.V. = Colour according to voltage

(*) Green may be used together with the colour of the operating range for frequencies above 60 Hz and up to a maximum of 500 Hz.

(**) For the code of products with nickel-plated contacts (socket holes, plug pins), add "N" to the pre-code of the corresponding standard product code; for example: PE becomes PEN and PEW becomes PEWN.

Dimensions in mm

(16 / 32A) PE ... PQ

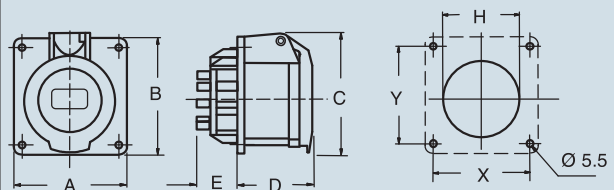

PE...PQ	A	B	C	D	E	H	X	Y
16A	2P+	65	65	71	52	27	60	52
	3P+	65	65	75	53	27	61.5	52
	3P+N+	80	80	86	53	27	70	60
32A	2P+	80	80	87	62	28	68	60
	3P+	80	80	87	62	28	68	60
	3P+N+	80	80	92	62	28	73	60

Dimensions indicated are not binding and may be changed without prior notice.

16A
IP67 degree of protection



32A
IP67 degree of protection



63A
IP67 degree of protection



125A
IP67 degree of protection



PEW...PQ

Part No.	Colour	Part No.	Colour	Part No.	Colour	Part No.	Colour
PEW 1643 PQ ⊕	Yellow	PEW 3243 PQ ⊕	Yellow	PEW 6343 PQ ⊕	Yellow	PEW 12543 PQ ⊕	Yellow
PEW 1663 PQ ⊕	Blue	PEW 3263 PQ ⊕	Blue	PEW 6363 PQ ⊕	Blue	PEW 12563 PQ ⊕	Blue
PEW 1693 PQ ⊕	Red	PEW 3293 PQ ⊕	Red	PEW 6393 PQ ⊕	Red	PEW 12593 PQ ⊕	Red
PEW 1673 PQ ⊕	Black	PEW 3273 PQ ⊕	Black	PEW 6373 PQ ⊕	Black	PEW 12573 PQ ⊕	Black
PEW 16123 PQ ⊕	A.V.	PEW 32123 PQ ⊕	A.V.	PEW 63123 PQ ⊕	A.V.	PEW 125123 PQ ⊕	A.V.
PEW 1623 PQ ⊕	(+)	PEW 3223 PQ ⊕	(+)	PEW 6323 PQ	(+)	PEW 12523 PQ	(+)
PEW 1633 PQ ⊕	A.V.	PEW 3233 PQ	A.V.	PEW 6333 PQ	A.V.	PEW 12533 PQ	A.V.
PEW 1683 PQ	A.V.	PEW 3283 PQ	A.V.	PEW 6383 PQ	A.V.	PEW 12583 PQ	A.V.
PEW 1644 PQ ⊕	Yellow	PEW 3244 PQ ⊕	Yellow	PEW 6344 PQ ⊕	Yellow	PEW 12544 PQ ⊕	Yellow
PEW 1694 PQ ⊕	Blue	PEW 3294 PQ ⊕	Blue	PEW 6394 PQ ⊕	Blue	PEW 12594 PQ ⊕	Blue
PEW 1664 PQ ⊕	Red	PEW 3264 PQ ⊕	Red	PEW 6364 PQ ⊕	Red	PEW 12564 PQ ⊕	Red
PEW 16114 PQ ⊕	Black	PEW 32114 PQ ⊕	Black	PEW 63114 PQ ⊕	Black	PEW 125114 PQ ⊕	Black
PEW 1674 PQ ⊕	Red	PEW 3274 PQ ⊕	Red	PEW 6374 PQ ⊕	Red	PEW 12574 PQ ⊕	Red
PEW 1654 PQ	Black	PEW 3254 PQ	Black	PEW 6354 PQ	Black	PEW 12554 PQ	Black
PEW 1634 PQ ⊕	Red	PEW 3234 PQ ⊕	Red				
PEW 1634 PQ ⊕	Red	PEW 3234 PQ ⊕	Red				
PEW 16104 PQ ⊕	(+)	PEW 32104 PQ ⊕	(+)				
PEW 1624 PQ ⊕	(+)	PEW 3224 PQ ⊕	(+)				
PEW 1645 PQ ⊕	Yellow	PEW 3245 PQ ⊕	Yellow	PEW 6345 PQ ⊕	Yellow	PEW 12545 PQ ⊕	Yellow
PEW 1695 PQ ⊕	Blue	PEW 3295 PQ ⊕	Blue	PEW 6395 PQ ⊕	Blue	PEW 12595 PQ ⊕	Blue
PEW 1665 PQ ⊕	Red	PEW 3265 PQ ⊕	Red	PEW 6365 PQ ⊕	Red	PEW 12565 PQ ⊕	Red
PEW 1675 PQ ⊕	Black	PEW 3275 PQ ⊕	Black	PEW 6375 PQ ⊕	Black	PEW 12575 PQ ⊕	Black
PEW 1655 PQ	Black	PEW 3255 PQ	Black	PEW 6355 PQ	Black	PEW 12555 PQ	Black
PEW 16115 PQ ⊕	Red	PEW 32115 PQ ⊕	Red	PEW 63115 PQ ⊕	Red	PEW 125115 PQ ⊕	Red
PEW 1635 PQ ⊕	Red	PEW 3235 PQ ⊕	Red				
PEW 1635 PQ ⊕	Red	PEW 3235 PQ ⊕	Red				
PEW 1625 PQ ⊕	(+)	PEW 3225 PQ ⊕	(+)				

Dimensions in mm

(16 / 32A) PEW ... PQ

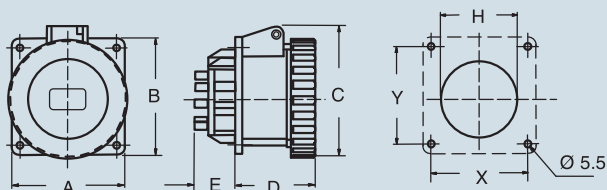

PEW...PQ	A	B	C	D	E	H	X	Y
16A 2P+⊕	65	65	77	52	27	60	52	52
3P+⊕	65	65	85	52	27	61.5	52	52
3P+N+⊕	80	80	93	52	27	70	60	60
32A 2P+⊕	80	80	98	62	28	68	60	60
3P+⊕	80	80	98	62	28	68	60	60
3P+N+⊕	80	80	105	62	28	73	60	60

Dimensions in mm

(63 / 125A) PEW ... PQ

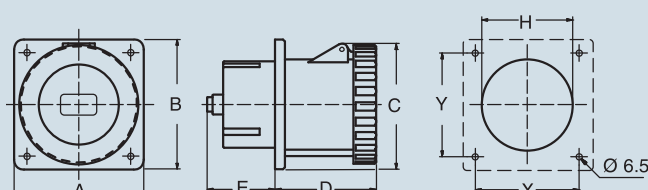

PEW ... PQ	A	B	C	D	E	H	X	Y
63A 2P+⊕	100	107	109	92	30	73	77	85
3P+⊕	100	107	109	92	30	73	77	85
3P+N+⊕	100	107	109	92	30	73	77	85
125A 2P+⊕	130	130	130	101	68	91	104	104
3P+⊕	130	130	130	101	68	91	104	104
3P+N+⊕	130	130	130	101	68	91	104	104